

Features

- Glass passivated chip
- Built-in strain relief
- Low inductance
- High peak reverse power dissipation
- Low reverse leakage
- For use in stabilizing and clipping with high power rating
- RoHS compliant

Mechanical Data

- Case: LL-41 Glass Case
- Lead: Solderable per MIL-STD-750, method 2026
- Epoxy: UL 94V-0 rate flame retardant
- Polarity: Color band denotes cathode end
- Mounting position: Any

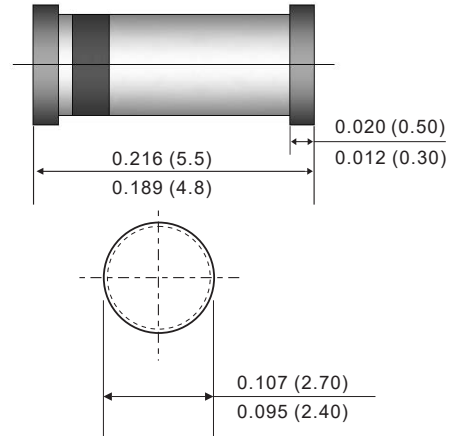

Unit: inch(mm)

LL-41

| Parameter | Symbols | Value | Unit |
|--|----------------|-------------|------------------|
| DC Power dissipation at $T_L = 75\text{ }^\circ\text{C}^{(1)}$ | P_D | 1.0 | W |
| Maximum forward voltage at $I_F=200\text{mA}$ | V_F | 1.2 | V |
| Junction temperature range | T_J, T_{STG} | -55 to +150 | $^\circ\text{C}$ |
| Storage temperature range | T_J, T_{STG} | -55 to +150 | $^\circ\text{C}$ |

Note :
 (1) T_L =Lead temperature at 3/8" (9.5mm)from body

| Part Number | Nominal Zener Voltage @I _T | | | I _{ZT} (mA) | Maximum Zener Impedance | | | Maximum Reverse Leakage Current | | Maximum DC Zener Current |
|-------------|---------------------------------------|-------------------------|-------------------------|----------------------|---|---|----------------------|--|--------------------|--------------------------|
| | V _{Z AVE.} (V) | V _{Z MIN.} (V) | V _{Z MAX.} (V) | | Z _{ZT MAX.} (Ω)@I _{ZT} | Z _{ZK MAX.} (Ω)@I _{ZK} | I _{ZK} (mA) | I _R (uA)@ V _R | V _R (V) | |
| DL4728A | 3.3 | 3.14 | 3.47 | 76.0 | 10.0 | 400.0 | 1.00 | 100.0 | 1.0 | 274.0 |
| DL4729A | 3.6 | 3.42 | 3.78 | 69.0 | 10.0 | 400.0 | 1.00 | 100.0 | 1.0 | 251.0 |
| DL4730A | 3.9 | 3.71 | 4.10 | 64.0 | 9.0 | 400.0 | 1.00 | 50.0 | 1.0 | 232.0 |
| DL4731A | 4.3 | 4.09 | 4.52 | 58.0 | 9.0 | 400.0 | 1.00 | 10.0 | 1.0 | 210.0 |
| DL4732A | 4.7 | 4.47 | 4.94 | 53.0 | 8.0 | 500.0 | 1.00 | 10.0 | 1.0 | 192.0 |
| DL4733A | 5.1 | 4.85 | 5.36 | 49.0 | 7.0 | 550.0 | 1.00 | 10.0 | 1.0 | 177.0 |
| DL4734A | 5.6 | 5.32 | 5.88 | 45.0 | 5.0 | 600.0 | 1.00 | 10.0 | 2.0 | 161.0 |
| DL4735A | 6.2 | 5.89 | 6.51 | 41.0 | 2.0 | 700.0 | 1.00 | 10.0 | 3.0 | 146.0 |
| DL4736A | 6.8 | 6.46 | 7.14 | 37.0 | 3.5 | 700.0 | 1.00 | 10.0 | 4.0 | 133.0 |
| DL4737A | 7.5 | 7.13 | 7.88 | 34.0 | 4.0 | 700.0 | 0.50 | 10.0 | 5.0 | 121.0 |
| DL4738A | 8.2 | 7.79 | 8.61 | 31.0 | 4.5 | 700.0 | 0.50 | 10.0 | 6.0 | 110.0 |
| DL4739A | 9.1 | 8.65 | 9.56 | 28.0 | 5.0 | 700.0 | 0.50 | 10.0 | 7.0 | 100.0 |
| DL4740A | 10.0 | 9.50 | 10.50 | 25.0 | 7.0 | 700.0 | 0.25 | 10.0 | 7.6 | 91.0 |
| DL4741A | 11.0 | 10.45 | 11.55 | 23.0 | 8.0 | 700.0 | 0.25 | 0.5 | 8.4 | 83.0 |
| DL4742A | 12.0 | 11.40 | 12.60 | 21.0 | 9.0 | 700.0 | 0.25 | 0.5 | 9.1 | 76.0 |
| DL4743A | 13.0 | 12.35 | 13.65 | 19.0 | 10.0 | 700.0 | 0.25 | 0.5 | 9.9 | 69.0 |
| DL4744A | 15.0 | 14.25 | 15.75 | 17.0 | 14.0 | 700.0 | 0.25 | 0.5 | 11.4 | 61.0 |
| DL4745A | 16.0 | 15.20 | 16.80 | 15.5 | 16.0 | 700.0 | 0.25 | 0.5 | 12.2 | 57.0 |
| DL4746A | 18.0 | 17.10 | 18.90 | 14.0 | 20.0 | 750.0 | 0.25 | 0.5 | 13.7 | 50.0 |
| DL4747A | 20.0 | 19.00 | 21.00 | 12.5 | 22.0 | 750.0 | 0.25 | 0.5 | 15.2 | 45.0 |
| DL4748A | 22.0 | 20.90 | 23.10 | 11.5 | 23.0 | 750.0 | 0.25 | 0.5 | 16.7 | 41.0 |
| DL4749A | 24.0 | 22.80 | 25.20 | 10.5 | 25.0 | 750.0 | 0.25 | 0.5 | 18.2 | 38.0 |
| DL4750A | 27.0 | 25.65 | 28.35 | 9.5 | 35.0 | 750.0 | 0.25 | 0.5 | 20.6 | 34.0 |
| DL4751A | 30.0 | 28.50 | 31.50 | 8.5 | 40.0 | 1000.0 | 0.25 | 0.5 | 22.8 | 30.0 |
| DL4752A | 33.0 | 31.35 | 34.65 | 7.5 | 45.0 | 1000.0 | 0.25 | 0.5 | 25.1 | 27.0 |
| DL4753A | 36.0 | 34.20 | 37.80 | 7.0 | 50.0 | 1000.0 | 0.25 | 0.5 | 27.4 | 25.0 |
| DL4754A | 39.0 | 37.05 | 40.95 | 6.5 | 60.0 | 1000.0 | 0.25 | 0.5 | 29.7 | 23.0 |
| DL4755A | 43.0 | 40.85 | 45.15 | 6.0 | 70.0 | 1500.0 | 0.25 | 0.5 | 32.7 | 22.0 |
| DL4756A | 47.0 | 44.65 | 49.35 | 5.5 | 80.0 | 1500.0 | 0.25 | 0.5 | 35.8 | 19.0 |
| DL4757A | 51.0 | 48.45 | 53.55 | 5.0 | 95.0 | 1500.0 | 0.25 | 0.5 | 38.8 | 18.0 |
| DL4758A | 56.0 | 53.20 | 58.80 | 4.5 | 110.0 | 2000.0 | 0.25 | 0.5 | 42.6 | 16.0 |
| DL4759A | 62.0 | 58.90 | 65.10 | 4.0 | 125.0 | 2000.0 | 0.25 | 0.5 | 47.1 | 14.0 |
| DL4760A | 68.0 | 64.60 | 71.40 | 3.7 | 150.0 | 2000.0 | 0.25 | 0.5 | 51.7 | 13.0 |
| DL4761A | 75.0 | 71.25 | 78.75 | 3.3 | 175.0 | 2000.0 | 0.25 | 0.5 | 56.0 | 12.0 |
| DL4762A | 82.0 | 77.90 | 86.10 | 3.0 | 200.0 | 3000.0 | 0.25 | 0.5 | 62.2 | 11.0 |
| DL4763A | 91.0 | 86.45 | 95.55 | 2.8 | 250.0 | 3000.0 | 0.25 | 0.5 | 69.2 | 10.0 |
| DL4764A | 100.0 | 95.00 | 105.00 | 2.5 | 350.0 | 3000.0 | 0.25 | 0.5 | 76.0 | 9.0 |

Ratings and Characteristics Curves ($T_A=25^\circ\text{C}$ unless otherwise noted)

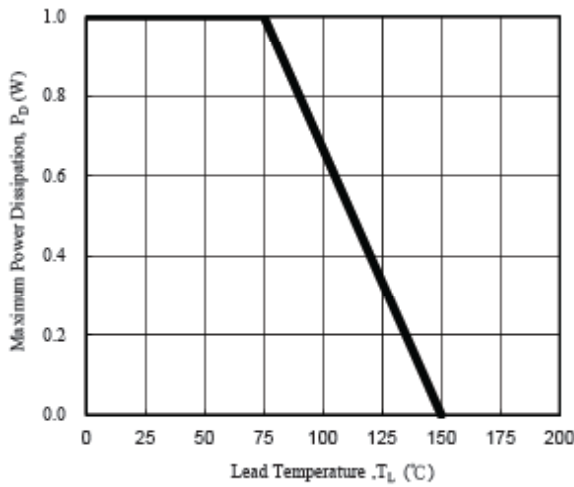

Fig. 1 - Power Temperature Derating Curve

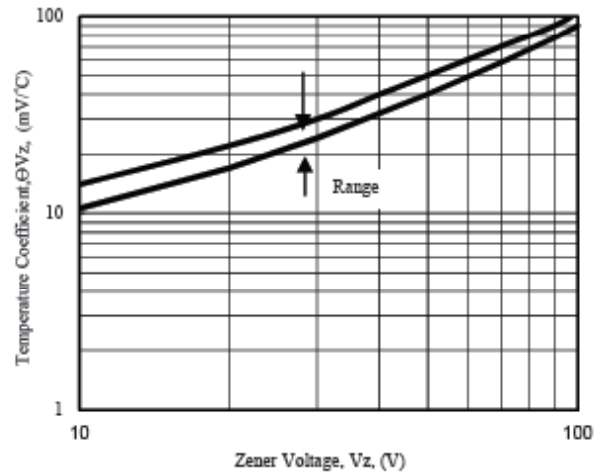

Fig. 2 - Temperature Coefficients v.s. Zener Voltage

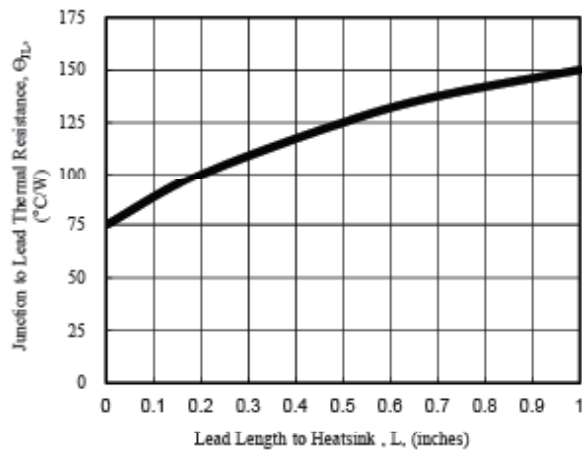

Fig. 3 - Typical Thermal Resistance v.s. Lead Length

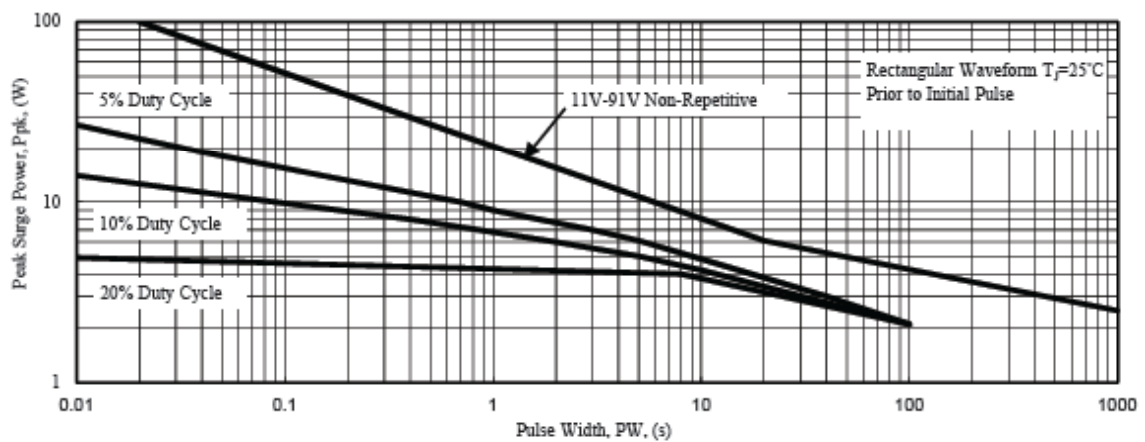

Fig. 4 - Maximum Surge Power